

# DOWNLIGHT



## CORN RW

<b>IP</b> 20/40	<b>CRI</b> >80/90	<b>AC220V</b>
--------------------	----------------------	---------------

Optional

 PHASE	 1-10V	 DALI
--	---	---

 3 YEAR GUARANTEE	 CITILED The Light Engine	 CE	 RoHS
---	---	---	---

### CORN RW

Corn RW is an innovative range of professional recessed lighting fixtures created to deliver a high lighting performance and suitable for most of the indoor applications. This series include the indoor recessed down light and track lights.

Integrated vertical light, adjustable tilt light, and wall washer with uniform light luminous effect.

Unique innovative design of die-casting heatsink, greatly increase heat dissipating efficiency.

Material : Aluminum Frame, reflector & heatsink

Applications : Hotels, Bars, Restaurants, Shopping centers and stores Showroom, Gallery, Office and administration buildings.



**luxio**  
L I G H T I N G

[www.luxio-lighting.com](http://www.luxio-lighting.com)

## References

Reference	Led Power	Luminous flux	CCT/K	OPTICS	IP Rating	Dimensions	Adjustable	
LX-DL-W11011	8W	701lm	2700K/3000K/4000K	15°/24°/38°/60°	IP20/IP40	88*123mm	——	
	12W	1026lm						
	15W	1129lm						
LX-DL-W11361	15W	1064lm				123*165mm		
	20W	1636lm						
	25W	1907lm						
	30W	2104lm						
LX-DL-W11611	25W	2056lm		148*194mm				
	30W	2310lm						
	36W	2899lm						
	40W	3267lm						
LX-DL-W11012	8W	722lm		15°/24°/38°/60°	IP20	88*116mm		°30/350°
	12W	997lm						
	15W	1105lm						
LX-DL-W11362	15W	1056lm				123*162mm		
	20W	1617lm						
	25W	1869lm						
	30W	2109lm						
LX-DL-W11612	25W	2047lm	148*195mm					
	30W	2306lm						
	36W	2889lm						
	40W	3210lm						

Order code : Reference - Power - Luminous flux - CCT/K - Optic

Important : All the specification can be customized as per the project request .

## OPTICS

LX-DL-W11611 / LX-DL-W11612



15°

24°

38°

LX-DL-W11011 / LX-DL-W11361 / LX-DL-W11012 / LX-DL-W11362



15°

24°

38°

60°

## Dimensions



LX-DL-W11011

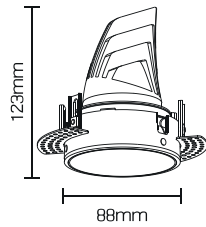

LX-DL-W11361

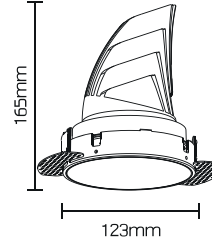

LX-DL-W11611

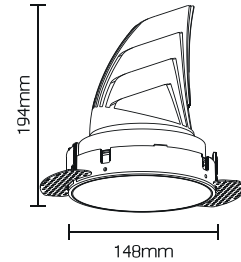

LX-DL-W11012

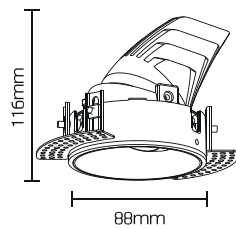

LX-DL-W11362

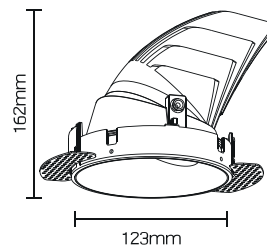

LX-DL-W11612

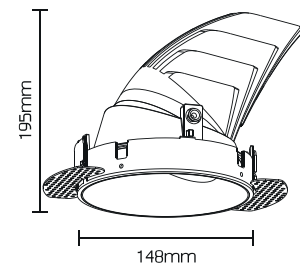

## Feature

To install:

⚠ MINIMUM CEILING THICKNESS Z:5mm  
MAXIMUM CEILING THICKNESS Z:20mm

⚡ Please make sure that mains is disconnected before proceeding!

1

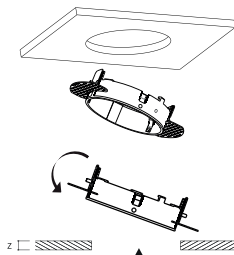

fit mounting kit into ceiling hole

2

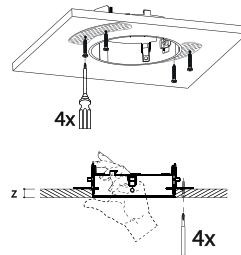

fix two brackets of mounting kit by 4 screws

3

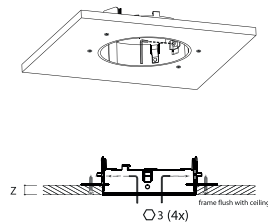

use hex wrench to tighten frame with brackets while adjusting the bottom of frame to be flush with ceiling

4

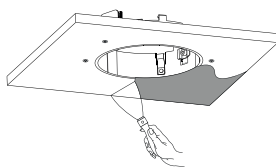

plaster ceiling to hide screws and mounting kit

5

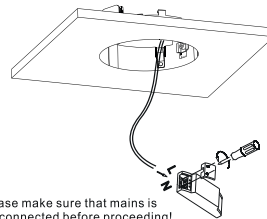

⚡ Please make sure that mains is disconnected before proceeding!

connect the power wires from AC power source to primary side(L&N) of driver, then connect driver and fitting by harness connector

6

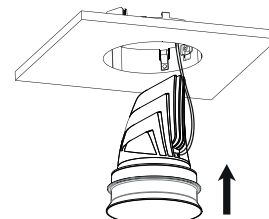

insert LED driver and all excess wires into ceiling then carefully insert light fitting into mounting kit until fitting is locked by springs inside of frame

