

HIGHBAY



LX-HB-02-G14

| | | |
|-----------------|-------------------|-------------------|
| IP 65 | AC110-277V | CRI >80 |
|-----------------|-------------------|-------------------|



HIGHBAY HB-02-G14

Factories, Steel Mills, Steel Smelting Plants, Manufacturing Plants & Warehouses Farms and Industrial Installations, sport Facilities & Workshops, Storage Facilities & Warehouses Supermarkets & Department Stores, Showrooms, Design Centers & Galleries.

Operating Temp.: -40°C ~+50°C

Operating Temp.: -40°C ~+80°C



References

| Reference | Led Power | Luminous flux | CCT/K | OPTICS | IP Rating | Dimensions | Net Weight |
|--------------|-----------|---------------|-----------------------------|--------|-----------|--|-----------------|
| LX-HB-02-G14 | 80W | 11200lm | 3000K/4000K /5000K/5700K | 100° | IP65 | P1 : 175(6.89")*320(Ø12.6") P2 : 208.5(8.21")*320(Ø12.6") | 2.50kg (5.5Lbs) |
| | 100W | 14000lm | | | | | |
| | 150W | 21000lm | | | | | |
| | 200W | 28000lm | | | | | |

Order code : Reference - Power - Luminous flux - CCT/K - Optic

Important : All the specification can be customized as per the project request .

Dimensions(mm)



(1)Chain



(2)Safety Rope



(3)Ceiling ring



(4)IP65 Waterproof Connector



(5)1.5m SAA/VDE/UL Rubber wire+ Plug (AU,EU,US,PSE,SW,UK)



(6)American hook



(7)PC Reflector

Others optional



P1



P2

Dimensions(mm)

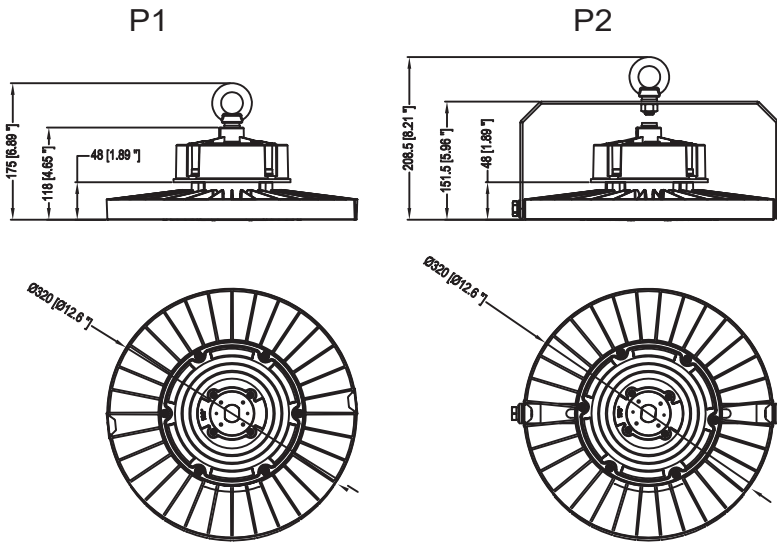

Installation and use

P1 Mounting Ring (Standard)

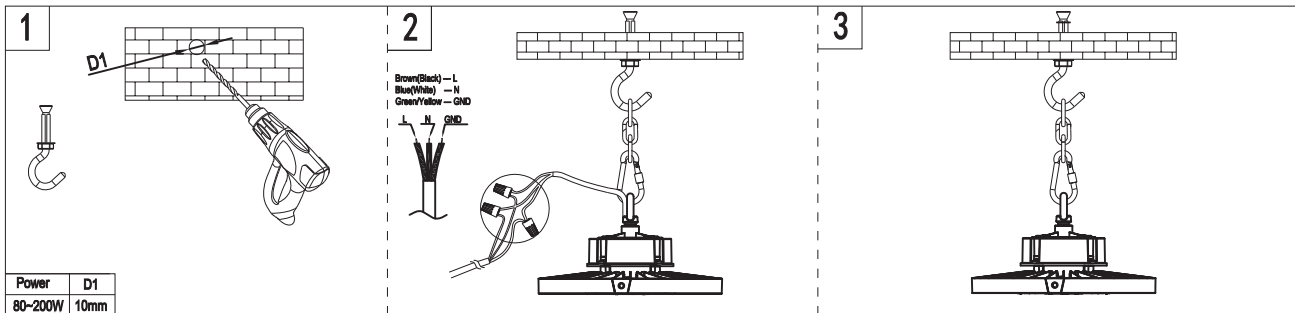

P2 Mounting Bracket

