

HIGHBAY

LX-HB-04-G3(C2)

IP 65	AC110-277V	CRI >80
-----------------	-------------------	-------------------



HIGHBAY HB-04-G3(C2)

Factories, Steel Mills, Steel Smelting Plants, Farms, sport Facilities & Workshops, Storage Facilities & Warehouses, Supermarkets & Department Stores, Showrooms, Design Centers & Galleries.

Microwave Motion Sensor

Operating Temp.: -40°C ~+50°C

Operating Temp.: -40°C ~+80°C



References

Reference	Led Power	Luminous flux	CCT/K	OPTICS	IP Rating	Dimensions	Net Weight
LX-HB-04-G3(C2)	80W	10 400lm	3000K/4000K/5000K /5700K	60°*100°	IP65	L313*H300*W64.50mm	3.00kg
	100W	13 000lm				L313*H300*W64.50mm	3.00kg
	150W	19 500lm				L590*H300*W64.50mm	4.90kg
	200W	26 000lm				L590*H300*W64.50mm	4.90kg
	300W	39 000lm				L967*H300*W64.50mm	8.00kg

Order code : Reference - Power - Luminous flux - CCT/K - Optic

Important : All the specification can be customized as per the project request .

Model Options



Dimensions(mm)

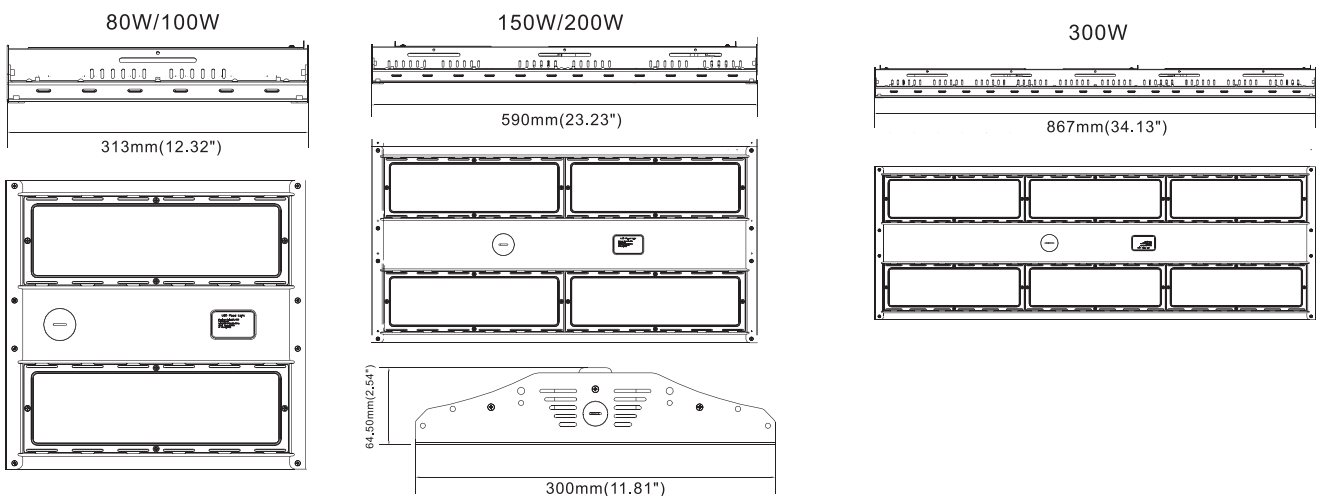

Installation and use

P1 Hanging Installation (Standard)

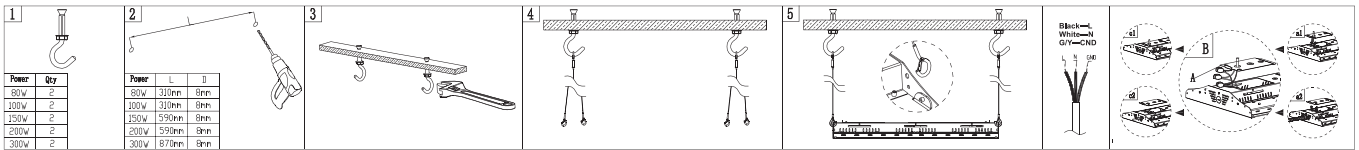

P2 Ceiling Installation

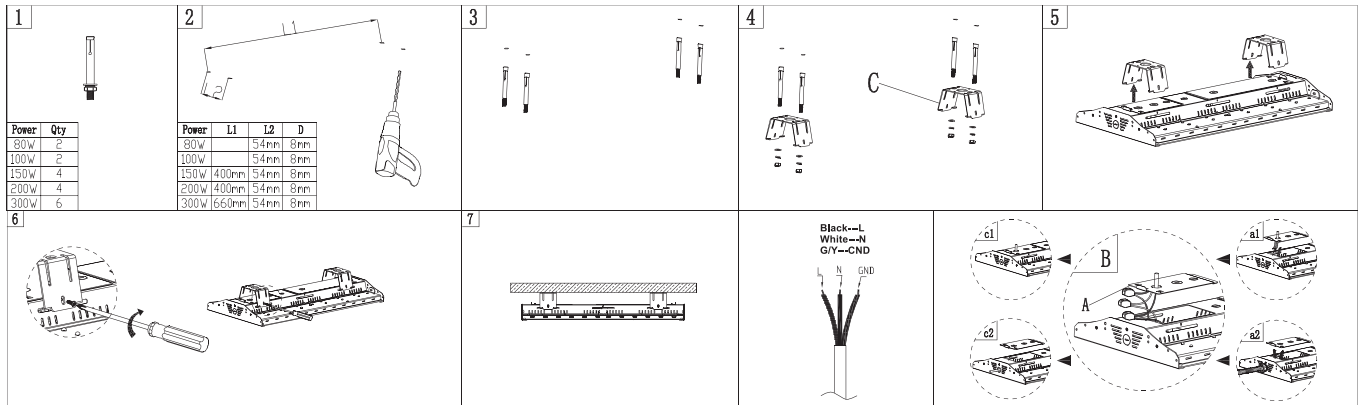

P3 Pole installation

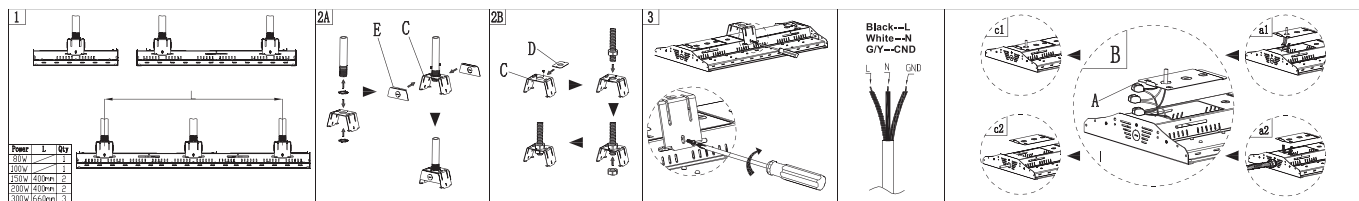

Sensor Optional

